

95 north to EXIT 80 Go EAST (RIGHT) TO Rt 7 Go EAST (LEFT) TO Hwy 40 Turn L (West)  
Go ABOUT 1 MILE Go Up UNDER OVERPASS MAKE A U TURN THEN 1st EXIT HICKORY AVE  
AT END TURN R THEN AT END TURN L ROAD GOES INTO PLANT

ABERDEN MARYLAND

LOC CODE 36931

800-523-9652

X-813

OR go Down

543<sup>E</sup> to 40<sup>N</sup>

295 - In Richmond  
(Towards D.C.)

495 - In D.C. (WASH)  
↳ go west (longer but less traffic)

Go thru town in  
Balt. no need  
to go around.

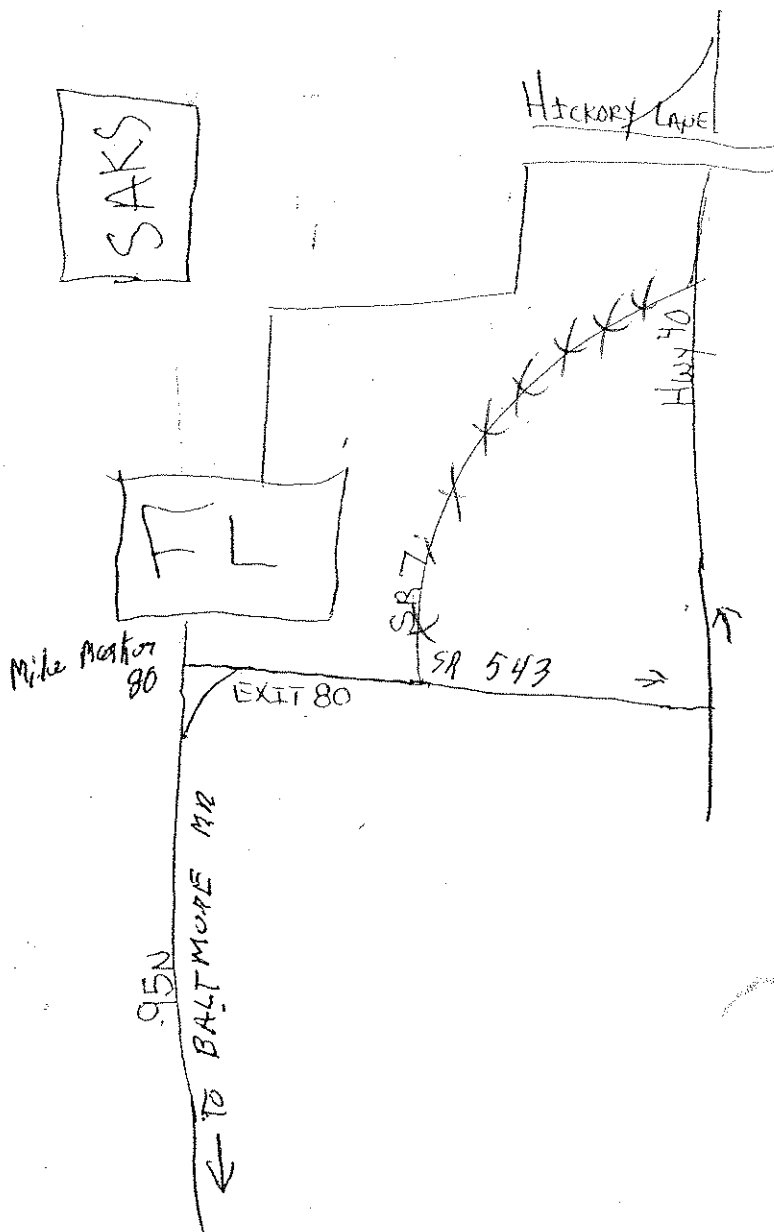

# ACCOMMODATIONS

- 1 Quality Inn - Flea BAG
- 2 Hampton Inn - nice PLACE
- 3 Miss Betty's Bed & Breakfast Inn
- 4 Comfort Inn
- 5 Days Inn
- 6 Best Western La Sammana
- 7 Heart of Wilson
- 8 Holiday Inn Express
- 9 Deluxe Inn
- 10 Kenwood Court
- 11 Jameson Inn
- 12 Sleep Inn
- 13 Microtel
- 14 Relax Inn
- 15 US Motel
- 16 Wayside Motel
- 17 Woodard Motel
- 18 Village Motor Lodge
- 19 Matthews Motel

# CAMPGROUNDS

- 20 Kampers Lodge
- 21 Rock Ridge Campground

# RECREATION

- 22 Happy Valley Country Club
- 23 Parks & Recreation Dept.
- 24 Wedgewood Public Golf Course
- 25 Willow Springs Country Club
- 26 Wilson Country Club

